

## How to Integrate Picreel With Cratejoy

**Picreel** lets you create **delightful** exit-intent **overlays** that help you **optimize** your **conversion rate** and retain users who are about to leave your website.

### Benefits of integrating Picreel with Cratejoy:

1. **Enhances** customer satisfaction.
2. Helps you **convert** up to an **additional 5%** of visitors exiting your website into customers.
3. Helps you **build an email list** for further interaction and engagement.

Here's an example of what the exit-intent overlay will look like after integrating Picreel with Cratejoy:

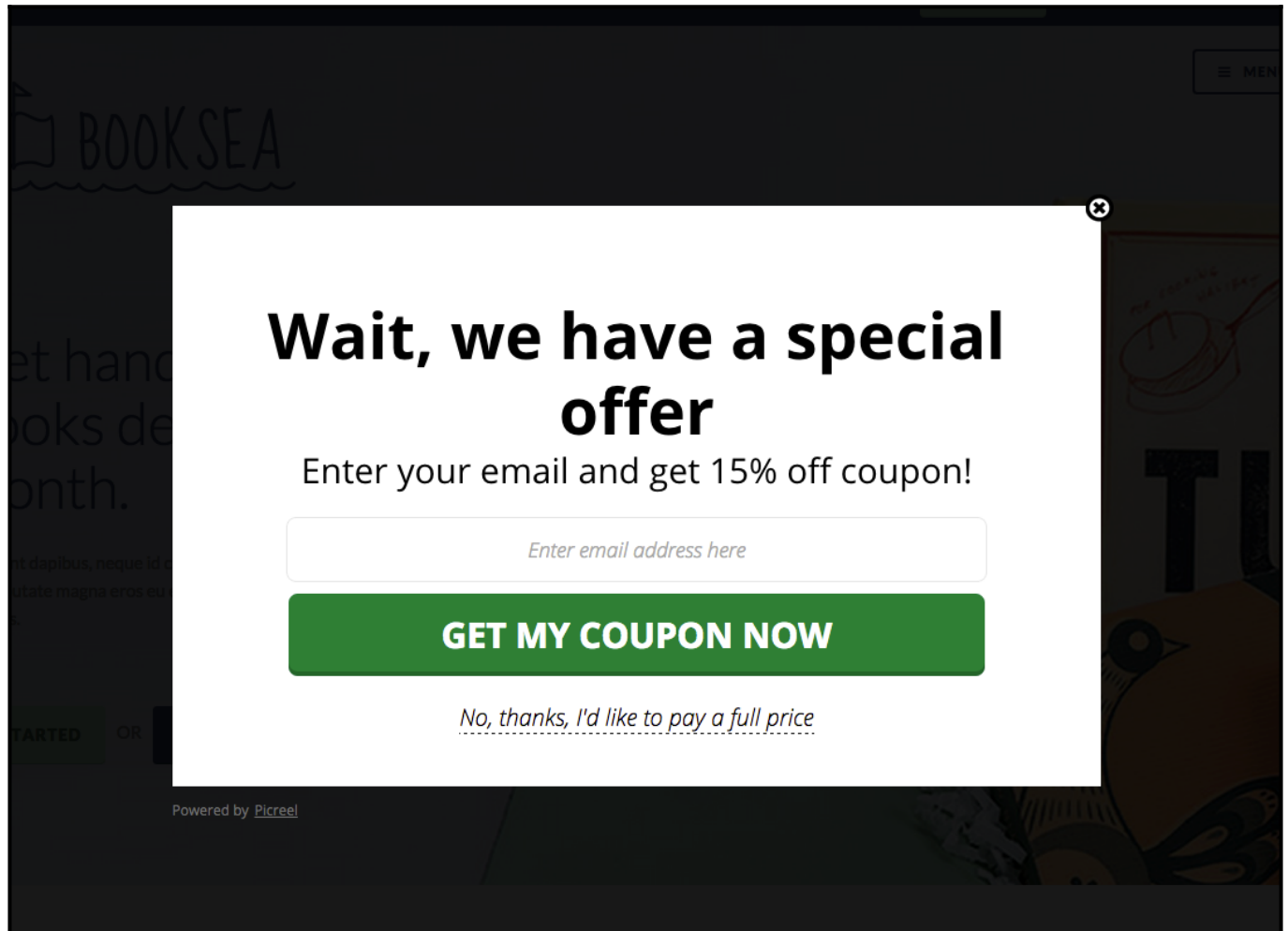

### To integrate Picreel with Cratejoy:

**Step 1:** Login into your **Cratejoy Seller** account.

**Step 2:** On the left navigation pane, click **Apps > App Store**.

**Step 3:** Scroll down and find **Picreel**. Click **Install** on the right side of the screen.

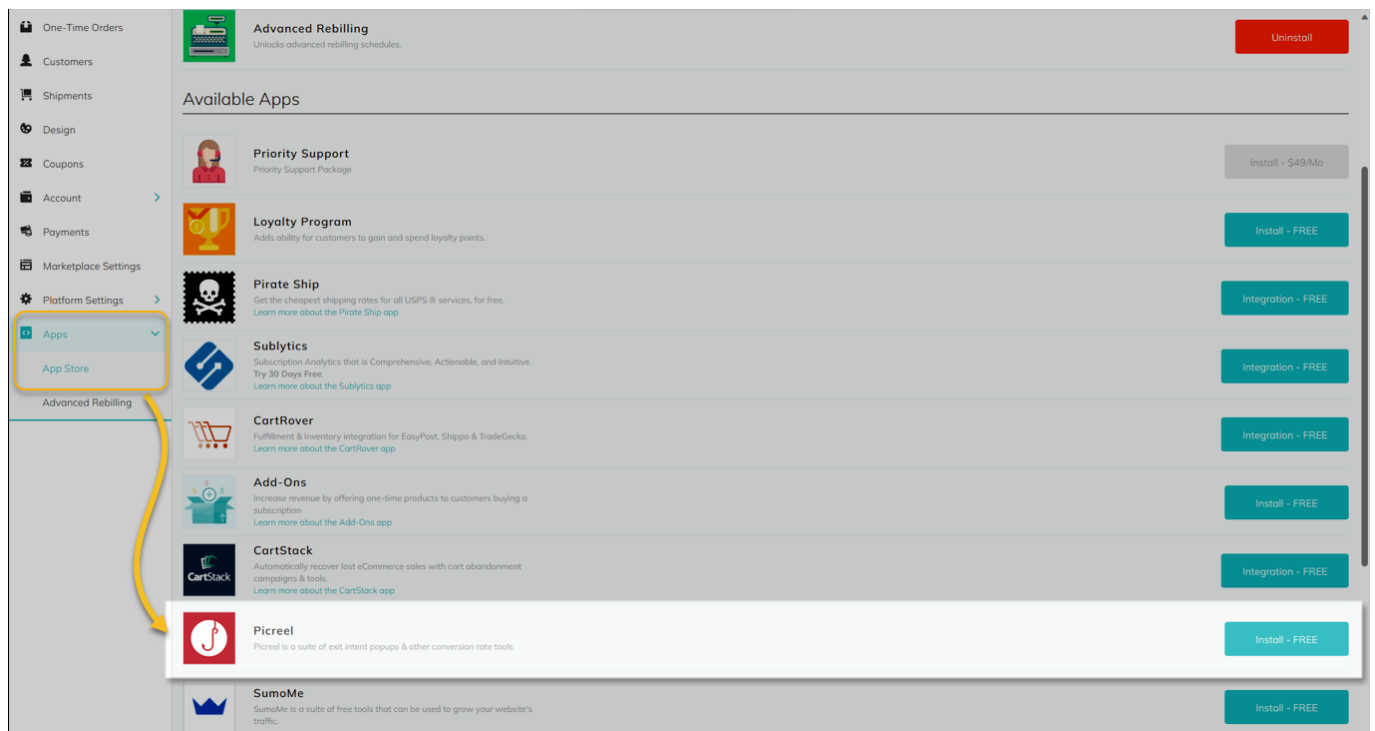

**Step 4:** In the overlay, click "**Install Picreel For Free.**"

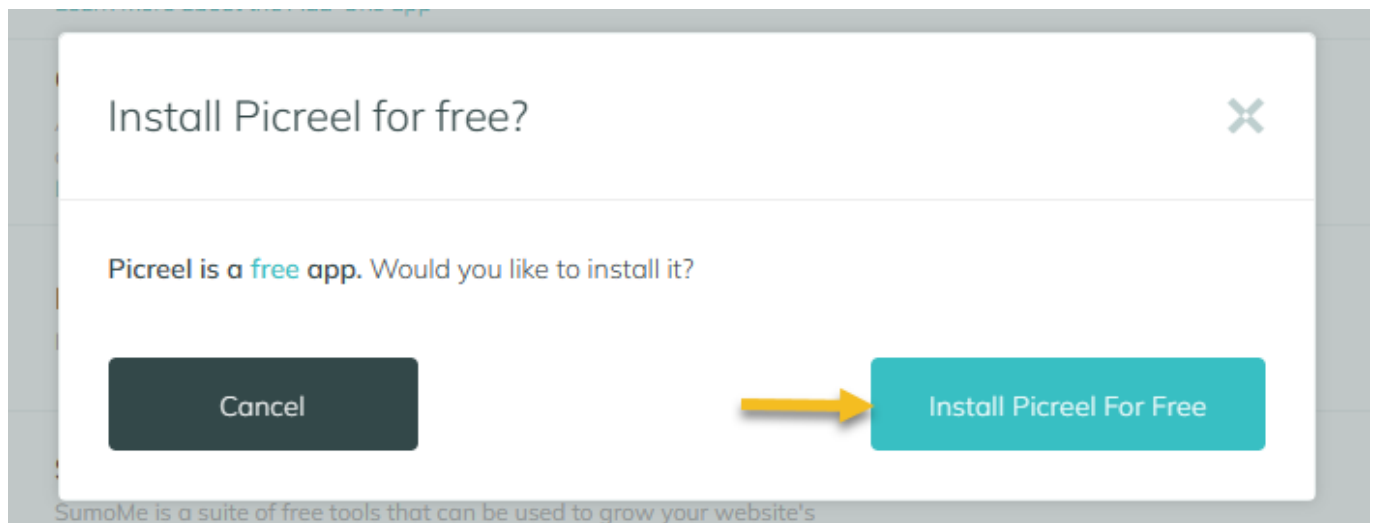

**Step 5:** Next, you will be redirected to a page to create a new Picreel account and set up a campaign.

## Picreel

### ✓ Code Inserted

```
<script src="//assets.pcr1.co/js/jstracker.min.js"></script>
```

The Picreel code has already been inserted into the <body> of your theme's HTML.

## 2. Create a Picreel account

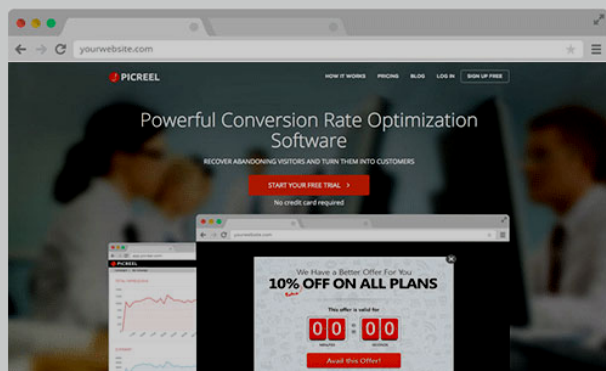

Create your Picreel account to get started. Make sure to enter the correct url for your storefront: <https://wallofjoy.cratejoy.com>.

[Sign Up For Your Account On Picreel](#)

[Need Help?](#)

For further information, *[check the help section of Cratejoy](#)*.

That's it! You have successfully integrated Picreel with Cratejoy.

### Related Articles:

- [How to Add Picreel Snippet Code via Google Tag Manager](#)
- [How to A/B Test Picreel's Pop-up Campaigns](#)
- [How to Set Overlay for a Specific Page](#)